



Vicars Moor Lane, Winchmore Hill, London, N21
Chain Free £525,000 Freehold

Anthony Webb
ESTATE AGENTS

Vicars Moor Lane, Winchmore Hill, London, N21

CHAIN FREE Victorian two bedroom terraced house located in the heart of Winchmore Hill N21.

The property, which requires MODERNISATION offers two receptions, a fitted galley kitchen, a spacious first floor shower room, two good size double bedrooms, double glazing, gas central heating, front and rear gardens.

Vicars Moor Lane is a popular residential turning located between Green Lanes and Wades Hill and is ideally placed for Winchmore Hill's wealth of shops (including a Waitrose within 2 minutes walk), restaurants, bus routes and mainline station into Finsbury Park and Moorgate.

Enfield Council Tax Band E

- Two double bedrooms
- Victorian terrace house
- Two receptions
- Kitchen
- First floor shower room
- Double glazing/gas central heating
- Front and rear gardens
- Close to shops/station





Vicars Moor Lane Winchmore Hill London N21 2QN

Tenure: Freehold
Gross Internal Area: 765.00 sq ft



Energy Efficiency Rating		Current	Potential
Very energy efficient - lower running costs			
(92 plus) A			
(81-91) B			
(69-80) C			
(55-68) D			
(39-54) E			
(21-38) F			
(1-20) G			
Not energy efficient - higher running costs			
England & Wales		EU Directive 2002/91/EC	
Environmental Impact (CO ₂) Rating		Current	Potential
Very environmentally friendly - lower CO ₂ emissions			
(92 plus) A			
(81-91) B			
(69-80) C			
(55-68) D			
(39-54) E			
(21-38) F			
(1-20) G			
Not environmentally friendly - higher CO ₂ emissions			
England & Wales		EU Directive 2002/91/EC	

GROUND FLOOR
389 sq ft. (36.1 sq m.) approx.

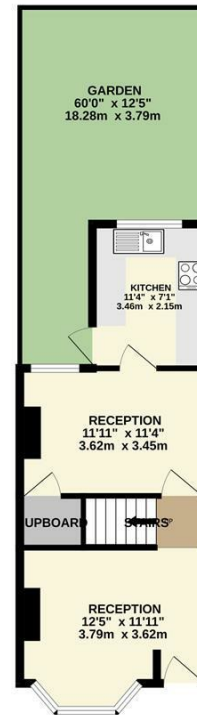

1ST FLOOR
377 sq ft. (35.0 sq m.) approx.



TOTAL FLOOR AREA: 765 sq ft. (71.1 sq m.) approx.
Whilst every attempt has been made to ensure the accuracy of the floorplan contained herein, measurements of doors, windows, rooms and any other items are approximate and no responsibility is taken for any error, omission or mis-statement. This plan is for illustrative purposes only and should be used as such for any prospective purchaser. The services, systems and appliances shown have not been tested and no guarantee as to their operability or efficiency can be given.
Made with Metropix ©2023

Property particulars as supplied by Anthony Webb Estate Agents are set out as a general outline in accordance with the Property Misdescriptions Act (1991) only for the guidance of intending purchasers of lessees, and do not constitute any part of an offer or contract. Details are given without any responsibility, and any intending purchasers, lessees or third parties should not rely on them as inspection or otherwise as to the correctness of each of them. We have not carried out a structural survey and the services, appliances and specific fittings have not been tested. All photographs, measurements, floor plans and distances referred to are given as a guide only and should not be relied upon for the purchase of carpets or any other fixtures statements or representations of fact, but must satisfy themselves by or of fittings, gardens, roof terraces, balconies and communal gardens as well as tenure and lease details cannot have their accuracy guaranteed for intending purchasers. Lease details, service ground rent (where applicable) are given as a guide only and should be checked and confirmed by your solicitor prior to exchange of contracts. no person in the employment of Anthony Webb has any authority to make any representation or warranty whatever in relation to this property.

348 Green Lanes, Palmers Green, London N13 5TJ
020 8882 7888
palmersgreen@anthonywebb.co.uk
anthonywebb.co.uk

Anthony Webb
ESTATE AGENTS